

Translation of the original instructions

Triton SLA

en English



Triton SLA

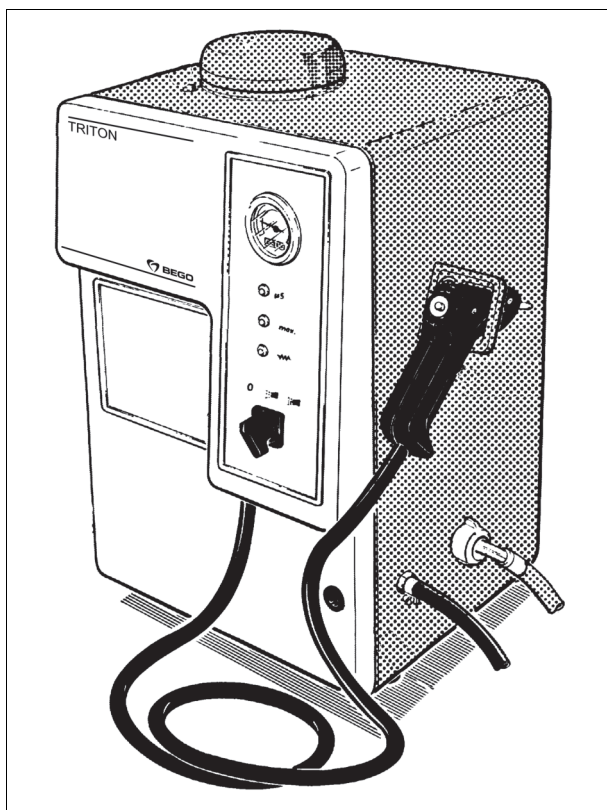

This unit documentation is part of the unit and must be enclosed when selling or passing on the unit.

- The unit has been designed solely for use in dental laboratories and comparable establishments for research, commercial and training purposes. The unit must only be operated by dental professionals, or they must provide supervision if trainees or other persons operate the unit.
- The operating instructions must be read and understood before the device is used. This particularly applies to the **Safety information**. The warranty is void in cases of damage which is caused by non-observance of the operating instructions. We will also not accept liability for any resulting consequential damages.
- Symbols used



This symbol indicates very important information. Failure to comply with it may result in personal injury.



This symbol warns about hot parts.

Table of contents

General Information	21
Safety Instructions.....	23
Unit description	25
Scope of delivery and Accessories	26
Technical Data.....	26
Installation	27
Operation	28
Service and Maintenance.....	30
Elimination of malfunctions	33
Signs, labels and stickers.....	34
Disposal	35
Spare parts list	Appendix
Wiring diagram	Appendix
Certificate of Conformity.....	Appendix

General Information

Importance of the operating Instructions

These operating instructions cover all the information that is necessary according to the relevant regulations for the safe operation of the device described herein.

The operating instructions are a part of the machine. The operating instructions should therefore

- always be kept at hand near the device until the device is disposed of,
- and should be passed on with the device when it is purchased, sold, or lent.

Contact the manufacturer if you do not understand something in the operating instructions.

We welcome any suggestions or criticism. Please feel free to notify us. Your effort will help us make the operating instructions more user-friendly and respond more effectively to your wishes and needs.

Target group

This document is directed toward everyone who works with this device or performs service tasks that are described in this document.

Contact information

BEGO Bremer Goldschlägerei Wilh. Herbst GmbH & Co. KG
Wilhelm-Herbst-Str. 1
28359 Bremen • Germany
Phone: +49 421 2028-0
Service-Hotline Phone: +49 421 2028-270
www.bego.com

© Copyright by BEGO Bremer Goldschlägerei Wilh. Herbst GmbH & Co. KG

This user guide is protected by copyright. All rights reserved.

No part of this document may be reproduced without the express written permission of BEGO Bremer Goldschlägerei Wilh. Herbst GmbH & Co. KG!

Conventions

These operating instructions contain references to residual hazards, important user tips and handling instructions that are identified with the following symbols and words.

DANGER

This reference identifies hazards that can cause serious bodily injury or death if the relevant hazard instructions are not followed or not followed properly.

WARNING

This reference identifies hazards that can cause bodily injury or property damage if the relevant hazard instructions are not followed or not followed properly.

ATTENTION

This reference identifies only those hazards that are potential damaging to property and the environment.

NOTE

This symbol identifies user tips and particularly useful information. It helps you optimally exploit all the functions of your machine.

1. Sequential actions are described in sequentially numbered paragraphs.
- Cross-references are identified with this symbol.

Warranty and Liability

Our general terms and conditions of sale and delivery apply. These are made available to the customer on completion of the contract, at the latest. Warranty and liability claims in the event of physical injury or damage to property are invalid if they are caused by one or more of the following:

- Improper use of the device
- Improper installation, putting into operation, operating and maintenance of the device;
- Operating the device with safety and protective facilities that are defective, improperly installed or inoperative
- Failure to heed the information in this manual concerning the transport, storage, installation, putting into operation, operation and service and maintenance of this device;
- Unauthorized structural modifications to this device;
- Inadequate monitoring/checking of parts of the device that are subject to wear;
- Improperly performed repairs;
- Catastrophes caused by alien elements or force majeure.

Safety Instructions

The Triton SLA is only intended for steam cleaning of dental and comparable objects. In order to avoid any damages by furring up, the Triton SLA has to be run with full demineralised water. Any other use is considered to be improper. We shall not be liable for any damage resulting from improper use.

General Safety Instructions

Place of use - The unit has been designed solely for use in dental laboratories and comparable establishments for research, commercial and training purposes.

The unit may only be installed on an adequately stable surface.

The unit must only be used in dry rooms.

Operator and operating personnel - The unit must only be operated by dental professionals, or they must provide supervision if trainees or other persons operate the unit.

Wear the protective clothing prescribed for use in dental laboratories and observe the rules of conduct.

The unit may only be operated by staff members who are familiar with and follow the instructions of this operating manual.

The operating manual must be easily accessible when the machine is operated. Observe the national accident prevention regulations in addition to this operating manual.

Handling the machine - Prior to the electrical connection check whether the specifications on the rating plate correspond to the power supply network. In the case of uncertainty, consult an electrician.

The unit is categorised under protection class 1 and may only be connected to properly earthed power sources (earth contact sockets).

Modifications of the machine are not permitted.

Always keep signs and stickers such that they are easy to read. They must not be removed.

The safety instructions must be followed in order to prevent personal injury and damage to the machine. We shall not be liable for damage due to failure to comply with the safety instructions.

Check the machine and leads for damage regularly. The machine must not be operated if it has any defects that may result in risks for the employees or third persons.

Protect the leads against heat, oil and sharp edges. The leads must not be used to carry the machine or to pull out the mains plug.

Repair work - Repairs may be carried out solely by BEGO customer service or by persons authorised by BEGO customer service.

Metallic housings must be grounded properly so as to prevent them from carrying current. Otherwise they are extremely dangerous because the housings may be live due to damage to the machine! Since a check to ensure a de-energized state is mandatory after every intervention in the machine (Germany: check in accordance with DIN VDE 0701-1), only qualified electricians may open the machine!

Only BEGO replacement and wearing parts may be used.

Care and maintenance - Switch off the machine and pull out the mains plug before performing any care, cleaning or maintenance work.

Only use dry or slightly moist cloths for cleaning. Do not spray the machine with water or immerse it in water.

Maintenance of safety-relevant components - The unit has been designed for a service life of 10 years from the date of manufacture. No liability is accepted for damages arising from operation of the unit after this period.

Special safety instructions regarding this machine

WARNING



Risk of scalding!

The temperature of the steam is over 65 °C!

Before starting work hold steam gun in a sink and press trigger. Do not start work until the steam is being emitted evenly.

Never hold the object to be cleaned with your fingers when cleaning with wet steam!

WARNING



Unit is under pressure!

Do not open the unit until the pressure has dropped to zero!

Ensure that the pressure gauge reads 0 bar or less before opening the cover, the demineralisation system or the drain cock.

NOTE

The Triton SLA is subject to the German Ordinance on Industrial Safety and Health (Betriebssicherheitsverordnung) in the Federal Republic of Germany. BEGO supplies each of its units with certification attesting that it has been manufactured in line with the specifications and has undergone quality testing. The enclosed test certificate must be retained.

In accordance with the German Ordinance on Industrial Safety and Health (BetrSichV. §10), correct assembly and commissioning of the unit must be performed by suitably qualified persons. The enclosed certificate regarding the installation must be signed by the aforementioned suitably qualified person and retained by the operator (BetrSichV. §11).

The relevant country-specific regulations governing the operation of units with a steam drum must be complied with.

Unit description

Triton SLA

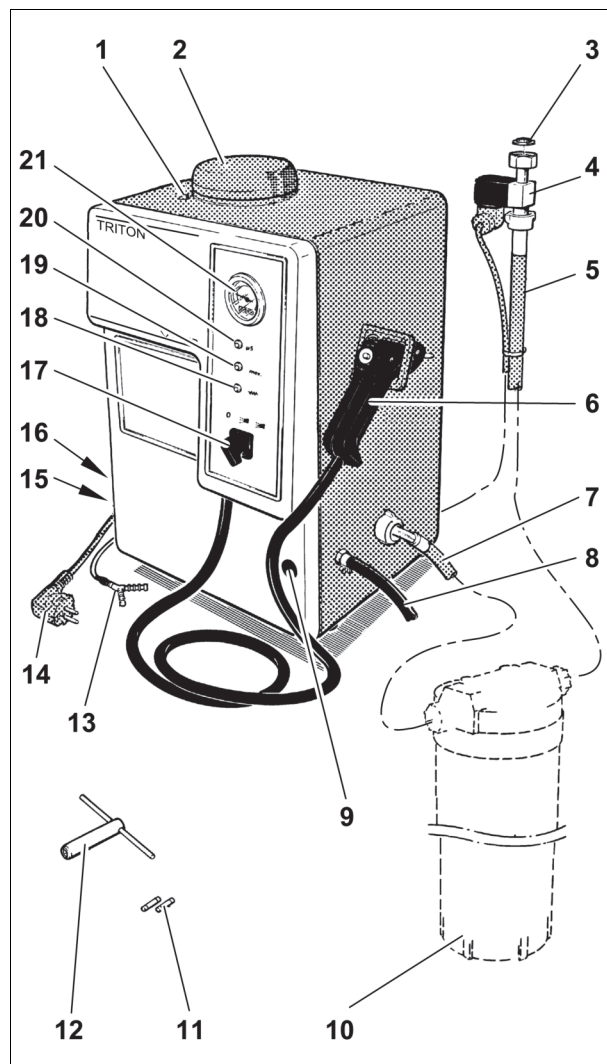

The Triton SLA is a versatile steam cleaner for the dental laboratory. Objects are cleaned and degreased with dry stream. Wet stream effectively removes wax residues and stubborn dirt.

- 1 Cover locking button
- 2 Lid/cover
- 3 Seal with strainer
- 4 Waterstop valve
- 5 Supply hose
- 6 Steam gun
- 7 Hose for full demineralisation cartridge
- 8 Waste hose
- 9 Drain cock
- 10 BEGO full demineralisation cartridge (accessory)
- 11 Spare fuses
- 12 Key for drain cock
- 13 Water leak detector
- 14 Mains plug
- 15 Fuses
- 16 Temperature limiter
- 17 Main switch
- 18 Heating indicator light
- 19 Indicator light for maximum water level
- 20 μS^* indicator light (conductivity/Waterstop)
- 21 Pressure gauge

* μS : international unit for electrical conductivity

NOTE

Please retain the original packing for future transportation!

Important:

In order to avoid any damages by furring up, the Triton SLA has to be run with full demineralised water. This is guaranteed when taking the BEGO-full demineralisation cartridge. Triton SLA is then automatically filled with water and used up water is replaced. In case that other demineralisation systems are applied, they have to ensure a conductivity from 0 up a maximum of 20 μS .

The Triton SLA is fitted with several safety devices:

- If the permissible operating pressure is exceeded the supply of water is interrupted and the heating switched off (switching range 3.5 ± 0.2 bar).
- A safety valve opens at 4.4 bar.
- If the boiler is heated without any water, a temperature limiter switches the heating off.

- A water leak detector, which is placed on the floor under the cleaner, measures electrical conductivity (μS) and switches the water supply off automatically in the event of a leak (μS indicator light comes on).
- If the full demineralisation cartridge is being used, the supply of water is interrupted when its resin is spent (μS indicator light comes on).

Scope of delivery and Accessories

NOTE

The spare parts list is appended.

When ordering spare parts please quote the REF, quantity and equipment serial no (SN).

Scope of delivery

Triton SLA

200...240 VAC, 50/60 Hz REF 26005

100...120 VAC, 50/60 Hz REF 26006

with:

- Key for drain cock
- Spare fuses
- Operating instructions
- BEGO full demineralisation cartridge (accessory)

Accessories

REF

BEGO full demineralisation cartridge, with 2 inserts and ring spanner 37600

Insert for full demineralisation cartridge with seal ring:

1 piece (new) 12260

1 piece (recycled) 12260 T

2 pieces (new) 37602

2 pieces (recycled) 37602 T

Durox non-reusable ion-exchanger resin, 6 l 52121

Ring spanner 11044

Calex 52125

Technical Data

Height 540 mm

Width 380 mm

Depth 280 mm

Weight 13 kg

Nominal voltage 200...240 VAC, 50/60 Hz

Special voltage 100...120 VAC, 50/60 Hz

Power consumption at nominal voltage 1.5 kW

Boiler temperature at pressure of 3 bar 133 °C

Steam pressure 3 ± 0.2 bar (ca. 0.3 MPa)

Boiler capacity 2.9 l

Water supply 3/4", 4...6 bar

Noise emission < 70 dB (A)

Installation

NOTE

In the **Federal Republic of Germany** proper installation must be certified using the "Installation Certificate" enclosed.

Preconditions

- Water supply 3/4", 4-6 bar with check-valve according to DIN EN 1717.

Important: Minimum water pressure 4 bar. A pressure-reducing valve must be connected if the water pressure exceeds 6 bar.

- See nameplate for mains electricity supply data.
- Fit BEGO full demineralisation cartridge to avoid scaling.

Important: Other demineralisation systems have to guarantee conductivity $\leq 20 \mu\text{S}$!

Position or wall-mount Triton SLA so that the steam gun can be used over a sink.

⚠ ATTENTION



Property damage!

The wall must be washable, since hot air is blown out of the back of the cleaner.

1. Set switch (1) to **0**.
2. Close drain cock (2) with key (3).
3. Press cover locking button (4) and firmly secure cover (5).
4. Place water leak detector (6) underneath the unit.

NOTE

The water control protects against water damages. When the poles A and B are connected by water (or metal), the water-stop valve is closed at the water supply hose and the indicator μS is on at the unit. Therefore place the water detector on a dry place underneath the unit - but not on metal.

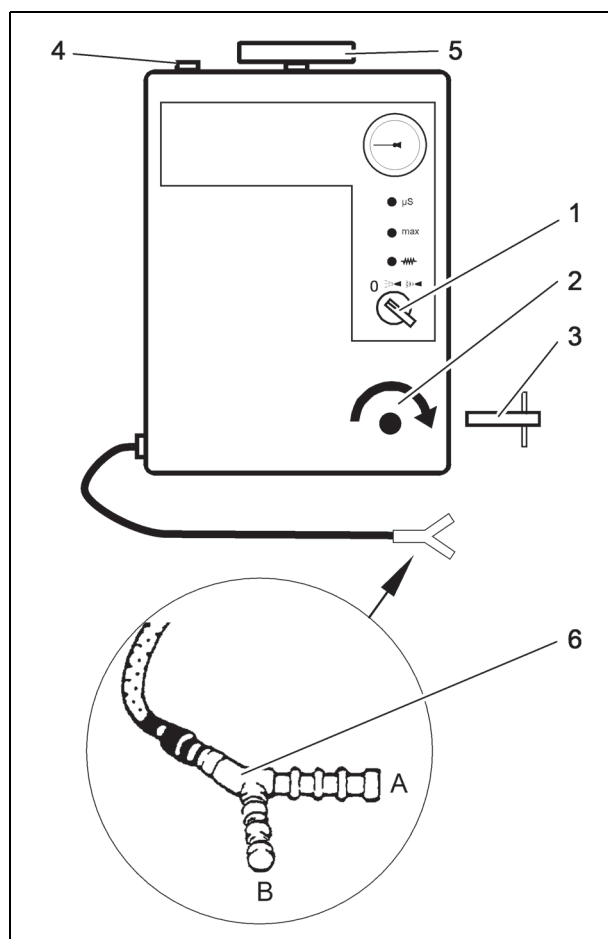

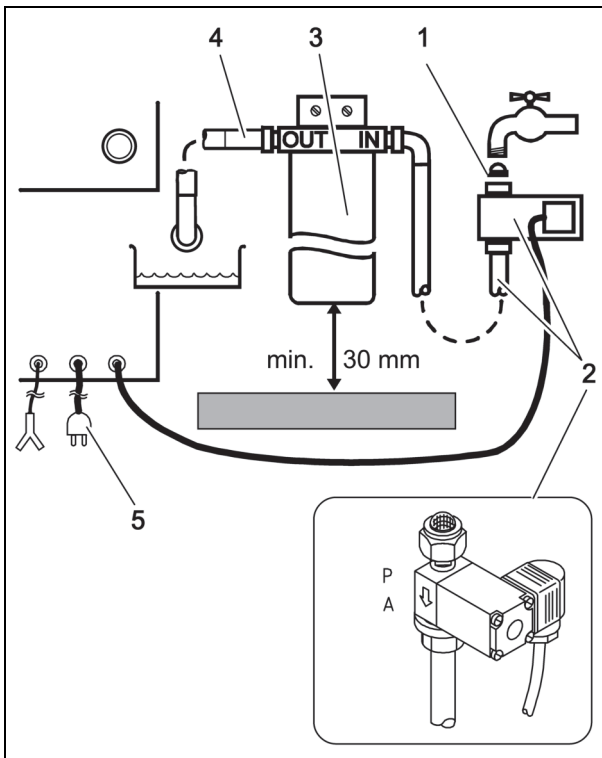

Connecting to supply of tap water

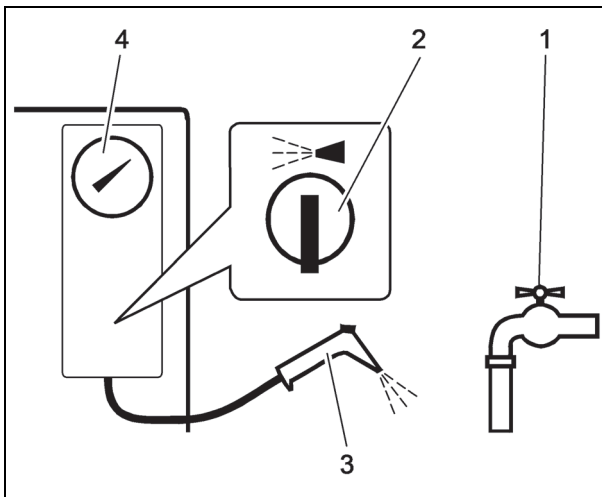

1. Fit seal with strainer (1).
2. Connect Waterstop valve and hose (2) tightly to **IN**.
3. Mount cartridge (3) **upright** (leaving minimum floor clearance of 30 mm).
4. Fit hose (4) to **OUT**. (Do not use metal pipe!)
Turn tap on and allow 2 or 3 litres of water to flow through. Then connect hose to Triton SLA.
5. Plug the unit in (5).

Operation



1. Turn tap (1) on.
2. Turn switch (2) to .
 - boiler is filled with water (takes about 3 minutes, when finished "max" indicator light comes on)
 - water is heated up ( comes on while heating).
3. **After about 15 minutes:** Hold steam gun (3) in a sink and hold trigger depressed until the steam is emitted evenly.
4. The cleaner is ready for operation when the reading on the pressure gauge (4) is about 3 bar.

Cleaning with dry steam

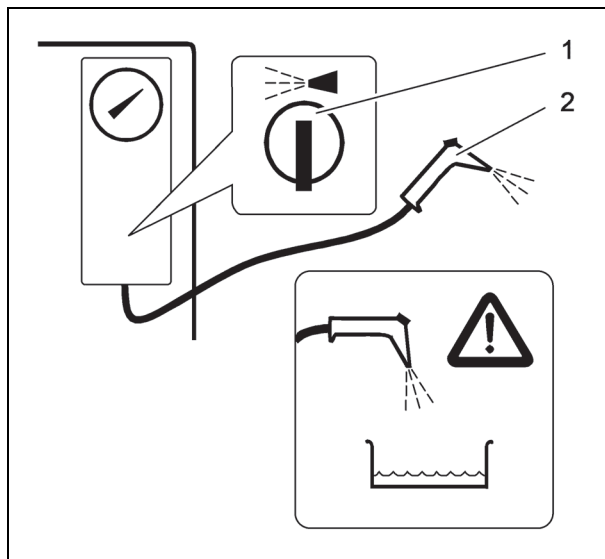

⚠ WARNING



Risk of scalding!

Before starting work hold the steam gun in the sink and hold trigger depressed until the steam is being emitted evenly and is free from water droplets.

The temperature of the steam is over 65 °C!

1. Set switch (1) to .
2. Use steam gun (2).
Hold gun 2 to 3 cm away from the object.

Cleaning with wet steam

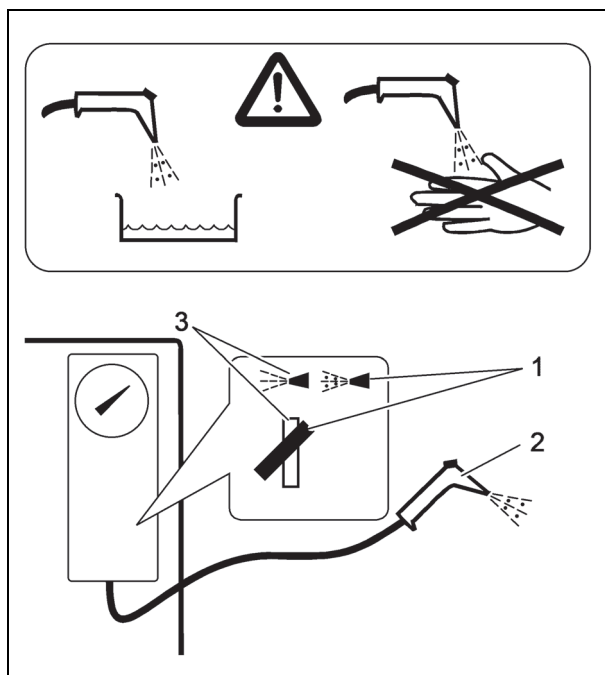

⚠ WARNING



Risk of scalding!

Before starting work hold the steam gun in the sink and hold trigger depressed until the steam is being emitted evenly.

Never hold the object to be cleaned with your fingers!

The temperature of the steam is over 65 °C!

1. Set switch (1) to .
 2. Use steam gun (2).
Hold gun 10 to 15 cm away from the object.
 3. Turn switch to .
- Water is topped up until the "max." indicator light comes on.

Switching off

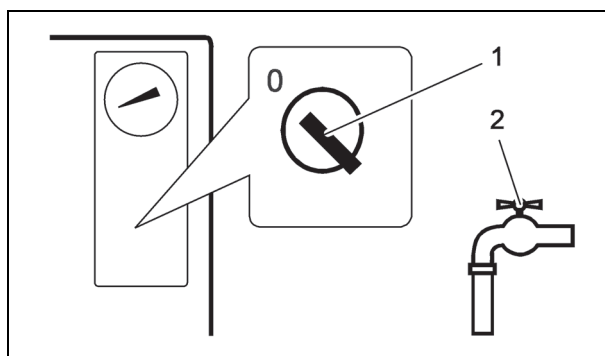

At the end of the working day:

1. Set switch (1) to 0.
2. Turn tap (2) off.

Service and Maintenance

⚠ DANGER



Warning of electric shock! Danger to life!

Switch off the machine and pull out the mains plug before performing any care or maintenance work.

Do not spray the machine with water or immerse it in water.

⚠ WARNING



Unit is under pressure!

Switch steam cleaner off and allow pressure to drop to zero!

Ensure that the pressure gauge reads 0 bar or less before continuing.

Do not open the unit until the pressure has dropped to zero!

Replacing the BEGO full demineralisation cartridge insert

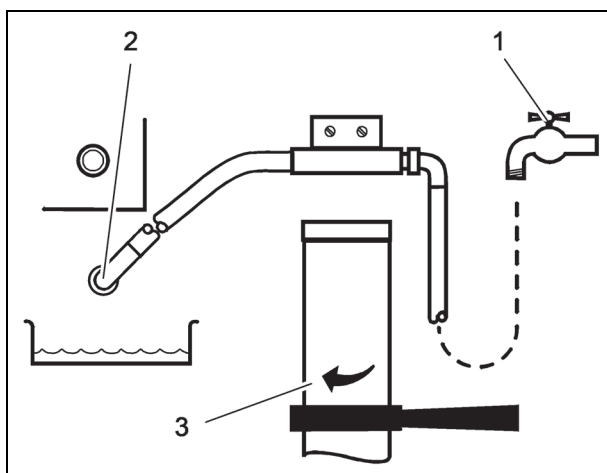

1. Turn tap (1) off.
2. Unscrew hose (2) and allow water to drain.
3. Unscrew casing (3) with ring spanner (see scope of supply of BEGO full demineralisation cartridge).

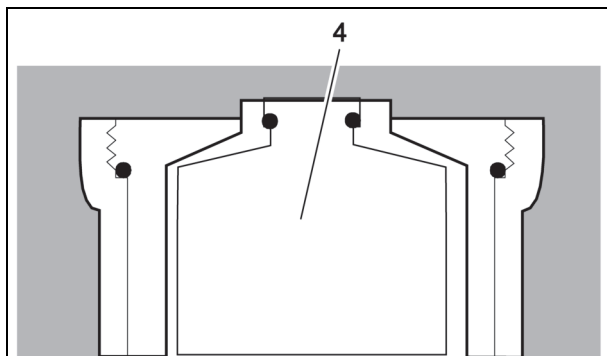

4. Replace insert (4).
Ensure the seals are correctly positioned.

1 Insert (new) REF 12260

2 Inserts (new) REF 37602

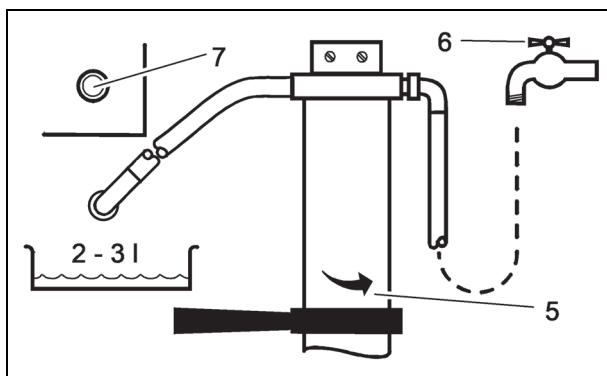

5. Screw casing (5) on again tightly using ring spanner.
6. Turn tap (6) on, allow 2 or 3 litres of water to flow through, turn tap off.
7. Screw hose (7) on tightly.

Refilling the BEGO full demineralisation cartridge

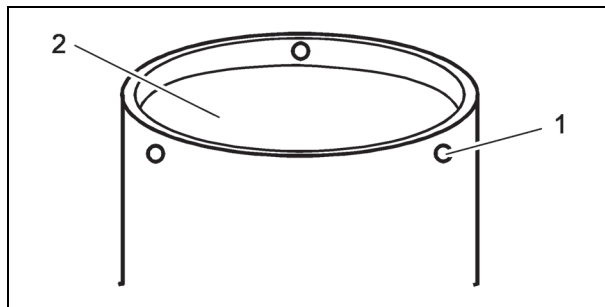

You can also fill the inserts with Durox yourself if you want to:

Durox non-reusable ion-exchanger resin, 6 l 52121

1. Pull rivets (1) out.
2. Remove bottom section (2).

NOTE

Dispose of spent resin in the same way as synthetic resin.

3. Wash insert thoroughly under running water.
4. Pour in about 2.3 l of Durox replacement resin and compact by placing on a vibrator. Fill in Durox up to about 5 mm below the rivet-holes.

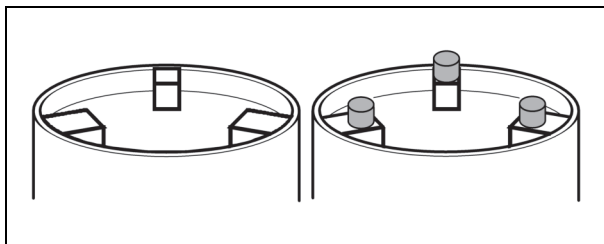

⚠ ATTENTION



Property damage!

There are different bottoms (see figure). To avoid damage when installing the inserts, do not interchange the bottoms!

5. Replace bottom section with rivets.
6. Fit seal ring (see “Replacing the BEGO full demineralisation cartridge insert”, page 30) and store insert so that it is protected from dust until used.

Discharging boiler

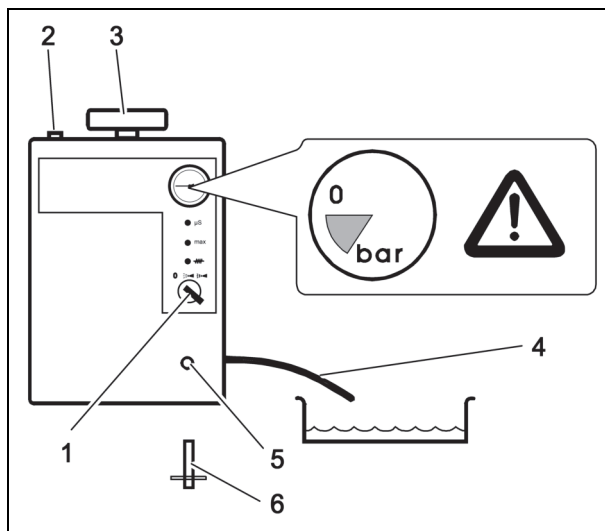

The emptying of the water out of the kettle can become necessary for the transport of the unit or for any other purposes.

1. Set switch (1) to 0.
 2. Press relief (2) and unscrew cover (3).
- Place hose (4) in water basing and open cock valve (5) with key (6).

Decalcification

When the BEGO demineralisation cartridge is exhausted, small quantities of salt penetrate into Triton SLA and after a time this leads to a calcification. Therefore decalcify Triton SLA regularly: when having a normal water hardness decalcifi-

cation should be carried out all six months, when having a high water hardness more often. **Damage caused by calcification is not covered by the guarantee!**

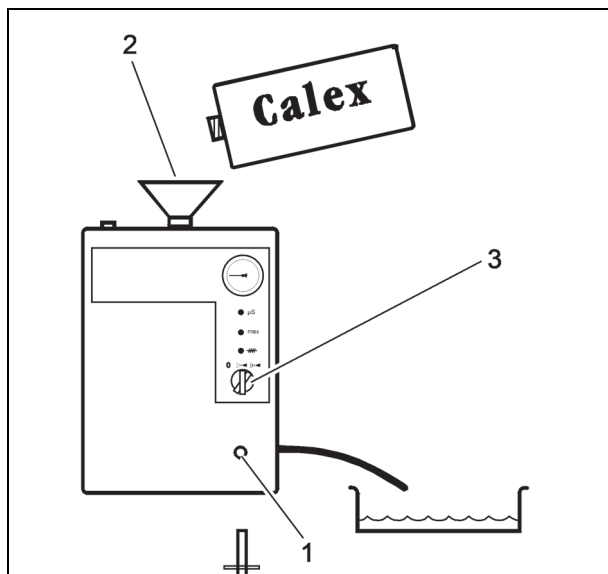

Filling with decalcifying agent

1. Discharge boiler (→ page 31).

NOTE

Only use Callex (REF 52125) since other decalcifying agents may leave residues!

2. Close drain cock (1)
3. Fill with 250 ml Callex (use funnel (2)).

Leave the cover of the unit open.

⚠ ATTENTION





Danger of boiling over!

Stop water intake immediately if the indicator  lights up.

During the heating up please do not leave the unit. If the water starts to boil in less than 10 minutes heating time, set switch immediately to 0 position.

Boiling over damages the unit!

4. Set switch (3) to .

Important: Immediately after indicator  lights up, set switch to  (water intake is stopped, water is heating up)!

After approx. 10 minutes heating up, set switch to 0 position!

Allow Callex to react for approx. 12 hours.

5. Open drain cock (1). Allow water to drain.

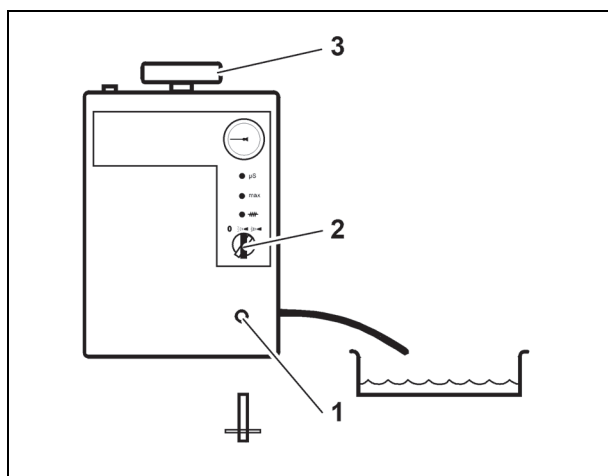

Flush boiler and close off

1. Close drain cock (1)
2. Set switch (2) to , wait until "max." indicator lights up, set switch to 0 position.
3. Open cock valve, allow water to drain off. Close drain cock.
4. Firmly secure cover (3).

Elimination of malfunctions

DANGER





Warning of electric shock! Danger to life!

Switch off the machine and pull out the mains plug before eliminating any malfunctions!

General remarks on eliminating malfunctions:

- Switch off the machine (exceptions: see *)
- Eliminate malfunction
- Switch on the unit
- Notify Service if messages appear repeatedly.
- Have servicing work carried out only by authorized BEGO workshops!

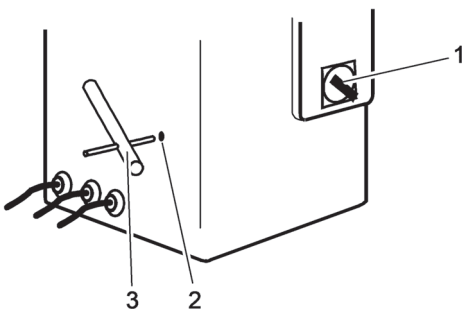
Service hotline: +49 (421) 2028 - (270...274)

Malfunction	Cause	Elimination
Indicator lights do not come on even though main switch is turned on	No current	<ul style="list-style-type: none"> • Plug unit in. • Check mains voltage. • Replace fuses.
"µS" indicator comes on	Water leak detector responds	Water leak detector must be dry and must not lie on metal surface.
	Resin in cartridge insert spent	Replace insert (→ page 30).
Unit not heating up	No water	<ul style="list-style-type: none"> • Turn tap on and / or • Switch temperature limiter on: <ol style="list-style-type: none"> 1. Set switch (1) to 0. 2. Unscrew dust cap, press temperature limiter with key (3), screw dust cap on again tightly.
		
Steam gun losing steam	Valve leaking	Contact customer service.
Cover leaking		 Do not open the unit until the pressure has dropped to zero! Replace cover seal.
Steam smells unpleasantly	Resin in cartridge insert spent	 Do not open the unit until the pressure has dropped to zero! Replace insert (→ page 30).

Signs, labels and stickers

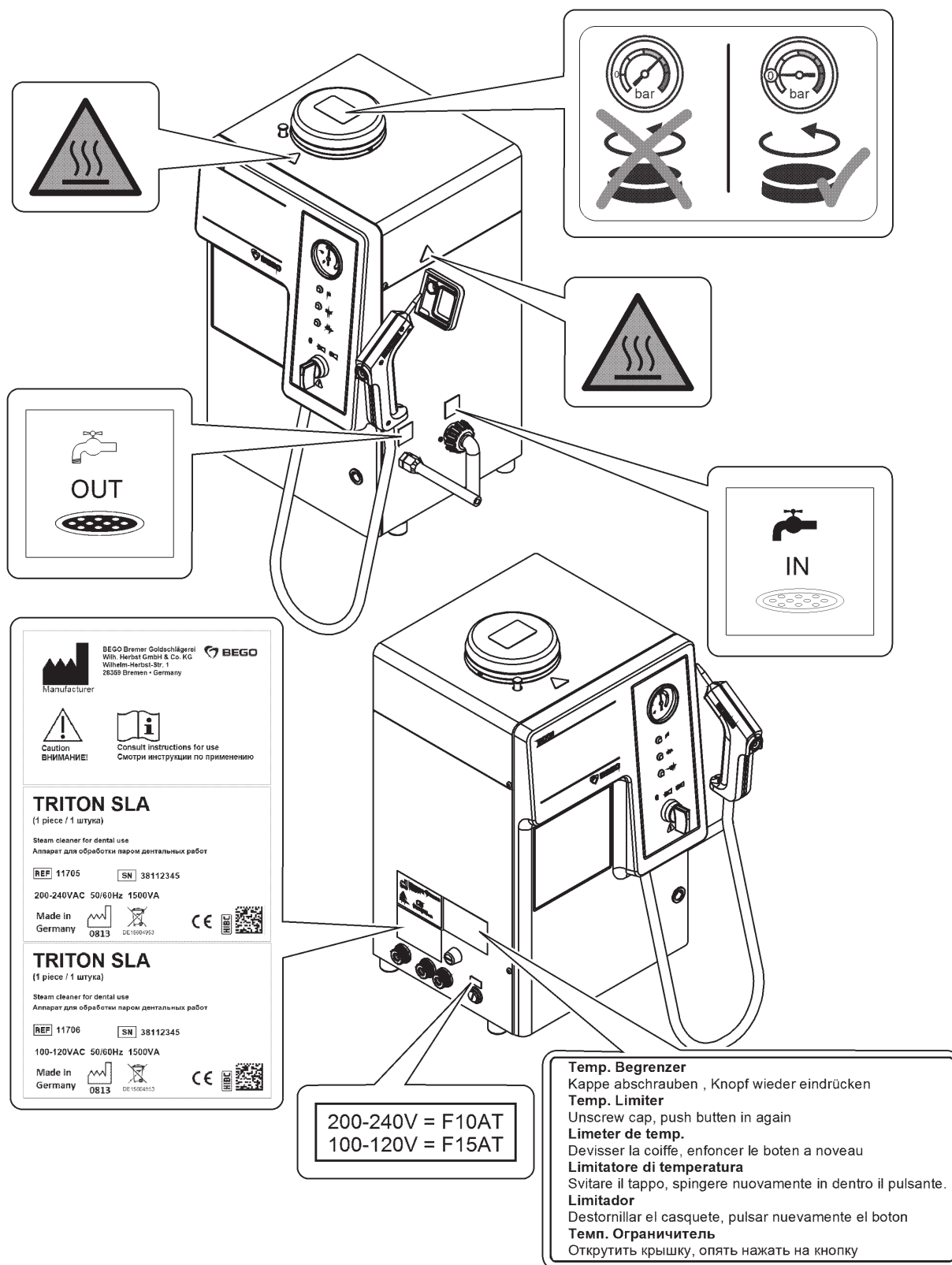

Disposal



Instructions for disposing of the device

(Applicable only within the European Union)

The adjacent symbol on the ID plate of the BEGO device indicates that the device, in accordance with the European directive on waste electrical and electronic equipment, may not be disposed of as normal domestic waste.

As a customer, you contribute to the protection of the environment when you dispose of the device correctly.

Disposal in Germany

BEGO offers you a disposal solution for all BEGO devices sold and put into operation in Germany subsequent to August 13, 2005. Please contact us when it is time to dispose of the device.

Disposal in other countries of the European Union

Please contact the company from which you purchased the BEGO device when it is time to dispose of it. They will provide you with information concerning correct disposal in your region.

